

# mCaliper Statistics

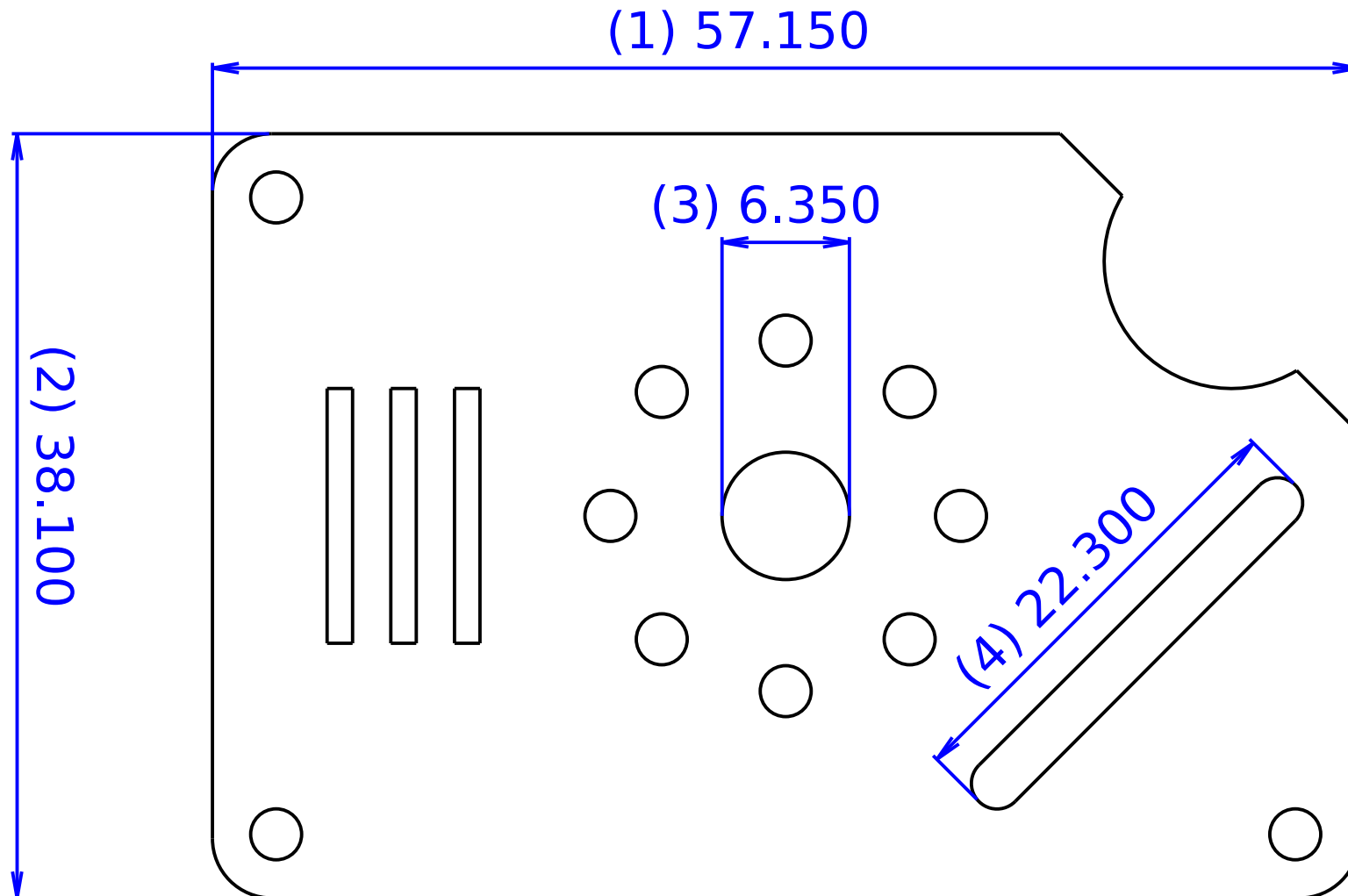

**PATENT PENDING**  
**mCALIPER**

Template:	QVI part
Filter:	Last 30 Measurements
Period:	NA - NA
Operators:	All
Tools	All
Date generated:	4/22/19, 10:32 AM



## mCaliper Statistics

Statistics	1	2	3	4
Nominal	57.150	38.100	6.350	22.300
Tolerance	+/-0.05080	+/-0.07620	+/-0.12700	+/-0.07620
Mean (M)	57.17640	38.11877	6.35570	22.28193
Std. Deviation (s)	0.09827	0.03647	0.03092	0.05497
Minimum	57.000	38.050	6.300	22.130
Maximum	57.640	38.190	6.400	22.370
Range	0.640	0.140	0.100	0.240
Cpk	0.0828	0.5250	1.3076	0.3525

Measurement	1	2	3	4
30 (4/10/19, 10:23 AM)	57.150	38.120	6.349	22.296
29 (3/14/19, 5:36 PM)	57.200	38.140	6.400	22.250
28 (3/14/19, 5:34 PM)	57.640	38.140	6.390	22.250
27 (11/26/18, 4:05 PM)	57.172	38.123	6.352	22.302
26 (10/29/18, 11:39 AM)	57.170	38.140	6.310	22.350
25 (8/30/18, 2:31 PM)	57.13	38.05	6.34	22.36
24 (8/29/18, 11:11 AM)	57.17	38.07	6.37	22.28
23 (8/23/18, 12:02 PM)	57.11	38.12	6.30	22.27
22 (7/11/18, 12:27 PM)	57.14	38.09	6.36	22.30
21 (7/11/18, 10:06 AM)	57.14	38.10	6.33	22.35
20 (7/11/18, 9:58 AM)	57.19	38.06	6.31	22.32
19 (7/11/18, 9:50 AM)	57.10	38.08	6.40	22.30
18 (7/11/18, 9:48 AM)	57.00	38.10	6.36	22.37
17 (6/28/18, 9:20 PM)	57.19	38.10	6.36	22.17
16 (6/28/18, 1:47 PM)	57.26	38.10	6.35	22.13
15 (6/11/18, 4:40 PM)	57.14	38.17	6.31	22.29
14 (6/11/18, 4:38 PM)	57.17	38.14	6.38	22.24

## mCaliper Statistics

Measurement	1	2	3	4
13 (6/11/18, 4:37 PM)	57.14	38.09	6.38	22.36
12 (5/21/18, 4:58 AM)	57.21	38.19	6.36	22.31
11 (5/15/18, 3:52 PM)	57.14	38.06	6.35	22.32
10 (4/13/18, 7:34 PM)	57.15	38.10	6.35	22.30
9 (4/13/18, 2:42 PM)	57.19	38.15	6.38	22.26
8 (4/11/18, 2:52 PM)	57.17	38.12	6.34	22.31
7 (4/11/18, 2:26 PM)	57.17	38.13	6.30	22.32
6 (4/11/18, 2:25 PM)	57.12	38.14	6.32	22.23
5 (4/4/18, 11:24 AM)	57.19	38.16	6.39	22.26
4 (4/2/18, 7:32 PM)	57.19	38.14	6.39	22.25
3 (3/28/18, 1:06 PM)	57.18	38.10	6.35	22.22
2 (3/27/18, 4:30 PM)	57.20	38.19	6.39	22.25
1 (3/27/18, 3:36 PM)	57.17	38.15	6.40	22.24

# mCaliper Statistics

(1) Width

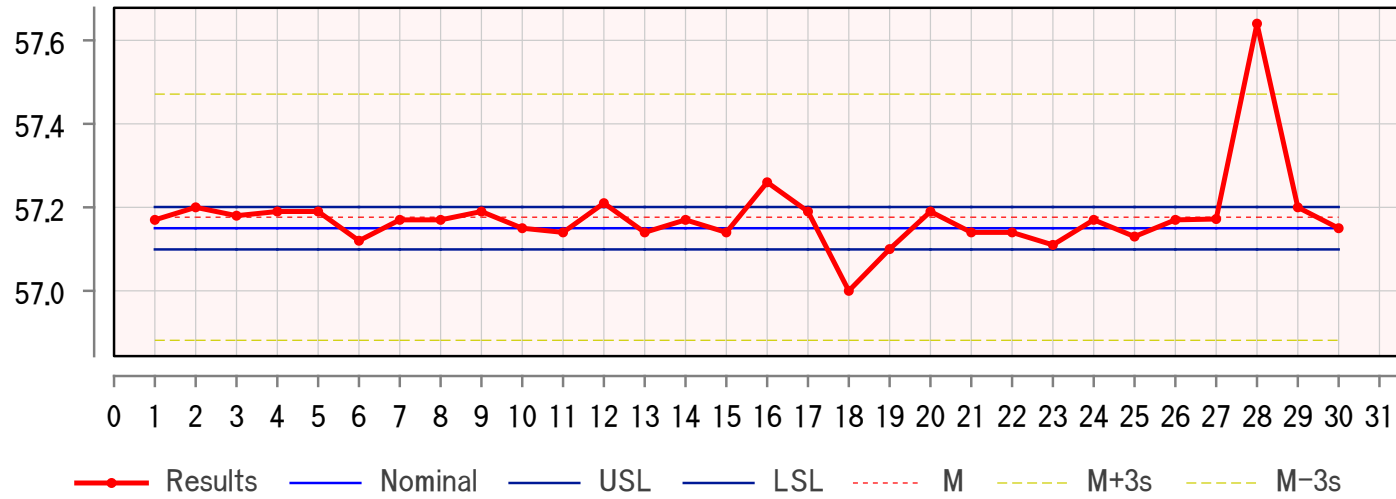

(1) Width

Nominal	57.150
Tolerance	+/-0.05080
Mean (M)	57.17640
Std. Deviation (s)	0.09827
Minimum	57.000
Maximum	57.640
Range	0.640
Cpk	0.0828

(2) Height

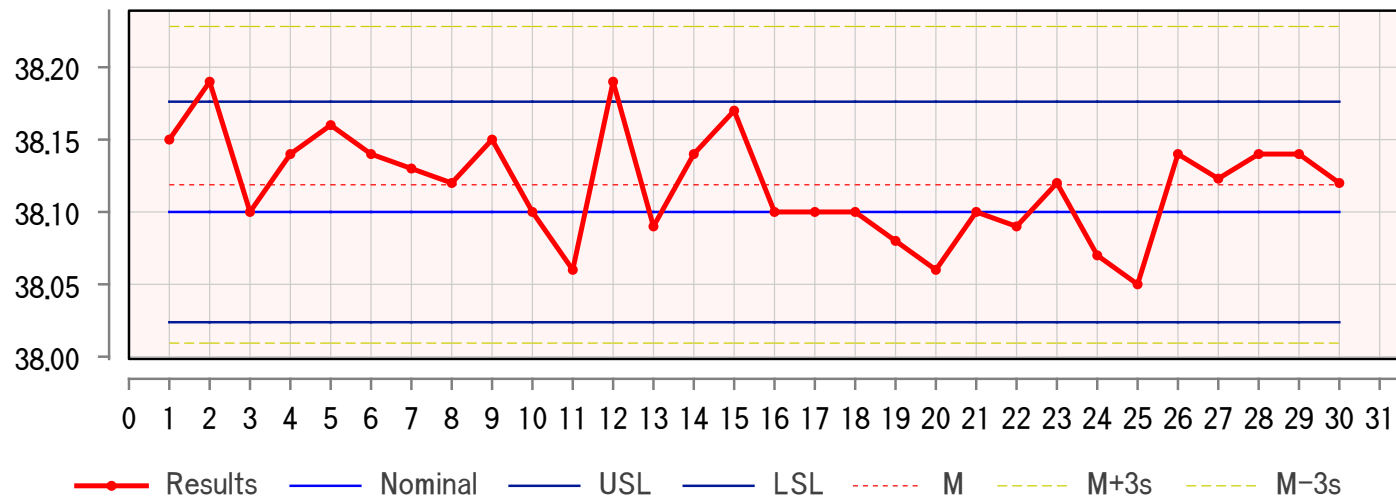

(2) Height

Nominal	38.100
Tolerance	+/-0.07620
Mean (M)	38.11877
Std. Deviation (s)	0.03647
Minimum	38.050
Maximum	38.190
Range	0.140
Cpk	0.5250

# mCaliper Statistics

(3) Hole diameter

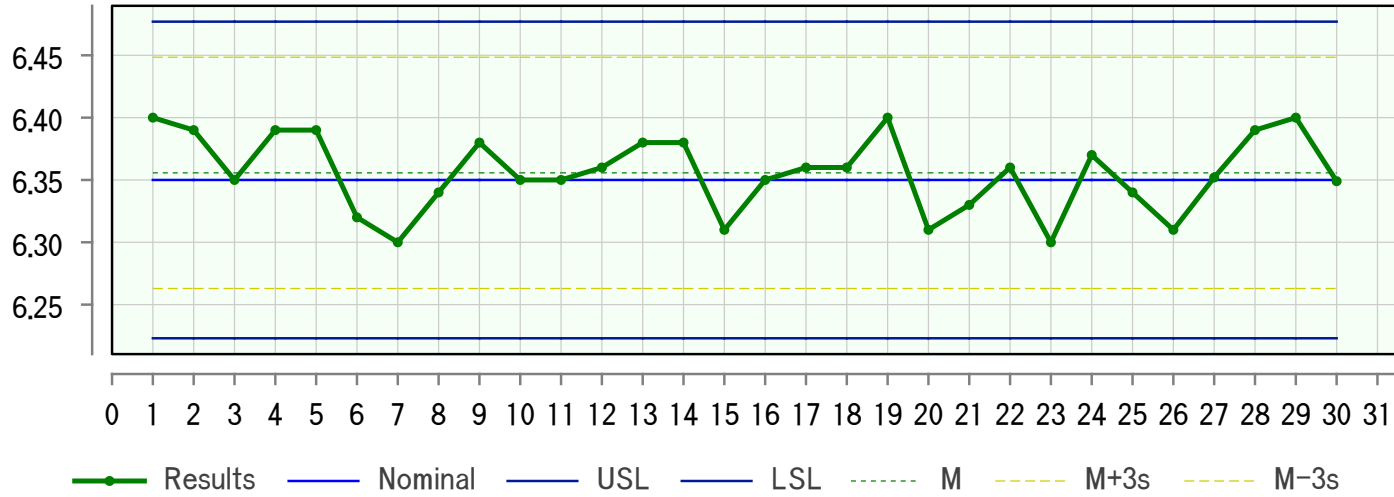

(3) Hole diameter

Nominal	6.350
Tolerance	+/-0.12700
Mean (M)	6.35570
Std. Deviation (s)	0.03092
Minimum	6.300
Maximum	6.400
Range	0.100
Cpk	1.3076

(4) Big slot width

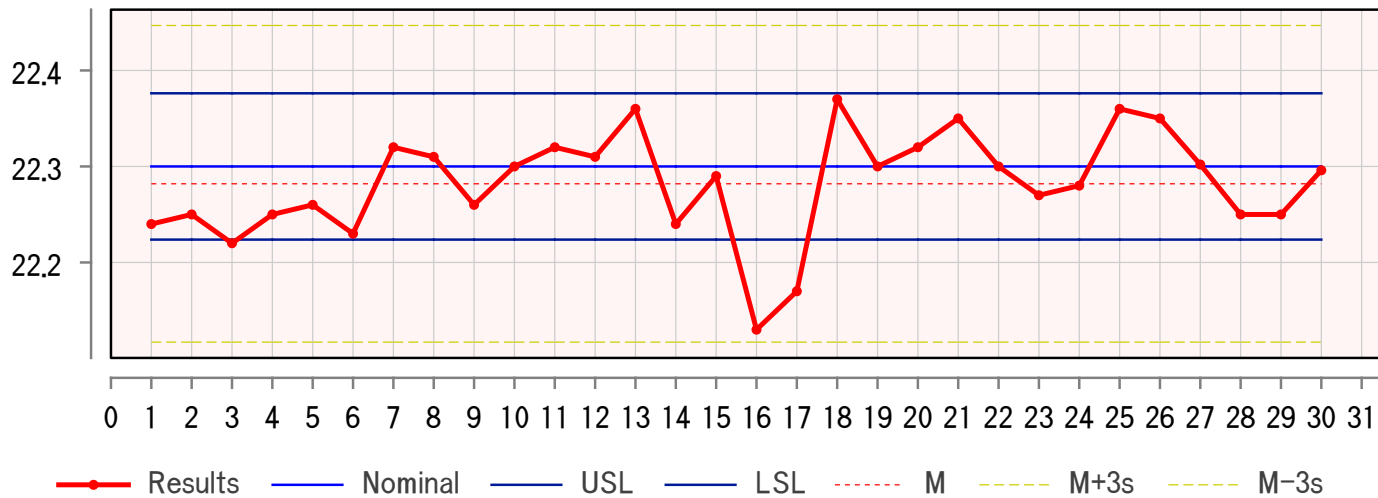

(4) Big slot width

Nominal	22.300
Tolerance	+/-0.07620
Mean (M)	22.28193
Std. Deviation (s)	0.05497
Minimum	22.130
Maximum	22.370
Range	0.240
Cpk	0.3525